

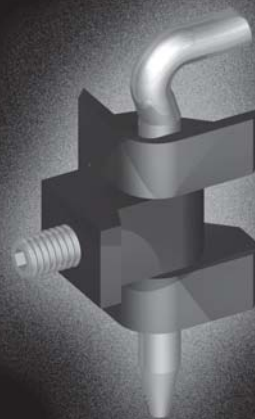

CUSTOMER • HARDWARE • SOLUTIONS

# HINGE CATALOG

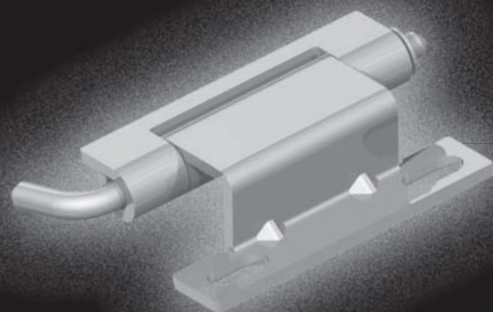
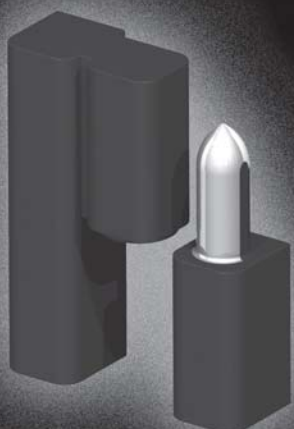

# Continuous Hinge

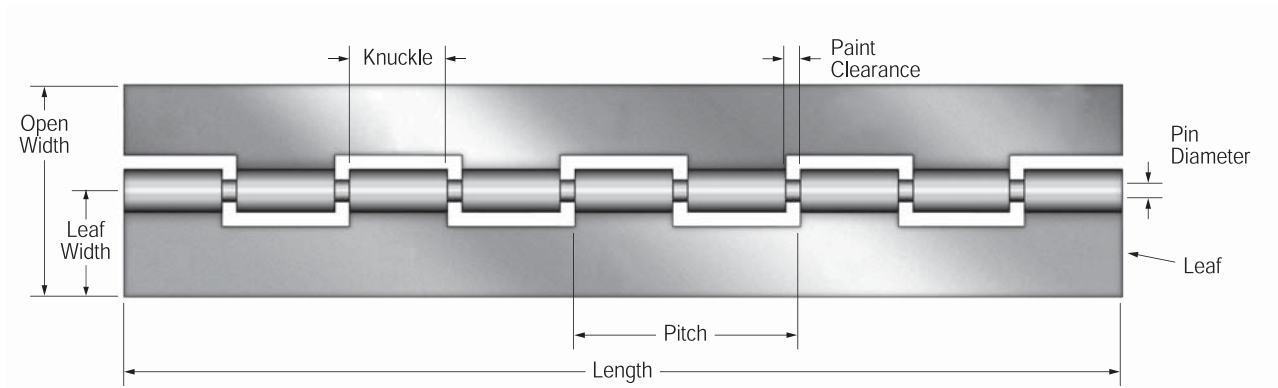

## Typical hinge properties

<b>Gauge:</b>	0.02" [0.5mm] to 0.250" [6.3mm]
<b>Open Width:</b>	0.75" [19mm] to 8.0" [203mm]
<b>Pin Diameter:</b>	0.062" [1.5mm] to 0.50" [12.7mm]
<b>Knuckle Length:</b>	1/4" [6.3mm] to 2.0" [50mm], 1/2" [12.7mm] is the most common.
<b>Standard Lengths:</b>	72" [1828mm], 84" [2133mm] & 96" [2438mm]
<b>Standard Materials:</b>	Steel, Stainless Steel and Aluminum
<b>Standard Finishes:</b>	Plain (bare metal), Zinc plate, Black (either black zinc plate or black powder coat)

## Hinge Geometry



**Standard**

Open leaves lay flat in the same plane, offset from the pin axis.



**Reverse Swaged**

Simulates reversed assembly, closed leaves are not parallel.



**Both Leaves Half-Swaged**

Open leaves lie in the same plane as the pin axis.



**One Leaf Half-Swaged**

Open leaves are not coplanar, and both lie below the pin axis. The swage is half the pin diameter.



**One Leaf Full-Swaged**

Closed leaves lie closely parallel. The swage is equal to the pin diameter.

*\*SWAGING is the forming of one or both leaves toward or beyond the centre of the pin.\**

## Formed and Unequal Leaves

Formed hinge leaves can be supplied in a variety of configurations. Width dimensions (W) should be taken from the pin centre line to the inside edge of the formed leaf. Height dimensions (H) of each formed leaf should be taken from the outside edge of the leaf, to the edge to the formed tip.

For unequal leaves, the widths are measured from the pin centre line, to the outer edge of each leaf.

**Formed Leaves**



**Unequal Leaves**



# Customise Your Hinge

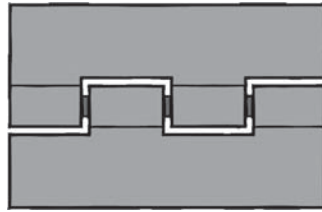

Full-End Knuckle

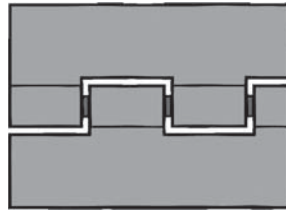

Partial-End Knuckle

## Length

Continuous hinges can be cut to exact lengths as required. Hinges should, however, be designed to a length that is a multiple of the knuckle length to eliminate partial knuckles. If a partial knuckle length cannot be avoided, please keep the following in mind:

1. Partial knuckle lengths should be the same as, or larger than, the knuckle diameter.
2. When partial knuckles are required on both ends, they should be on the same leaf.
3. Please be advised that continuous hinges with partial-end knuckles on one leaf may not rotate as freely as ones with full-end knuckles.

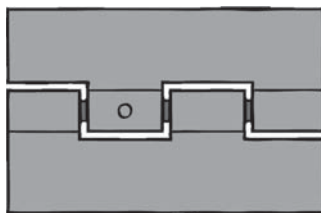

Flush Pin Staked

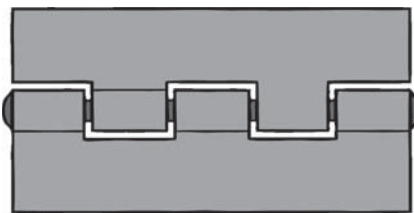

Pin Spun Both Ends

## Pin Retention

All standard continuous hinges are stocked with loose pins and flush cut ends, with the exception of steel and stainless steel hinges in thicknesses of .025" and .035", which will be staked to retain the pin. The following are among the methods used to retain the pins.

**Flush Pin Staked** - The most economical way to retain a pin is by staking it on the topside or backside of the knuckle.

**Pin Spun Both Ends** - This method is normally used only for tamper-proofing or for applications with severe vibrations.

## Pin Material

All standard hinges are supplied with like pin and leaf materials. However, a hinge can be ordered with a pin material different from the leaf. For example, a steel hinge with a brass pin.

## Piercing

Many designs for piercing are available. When ordering or requesting a quotation, include: hinge dimensions, hole diameter and type, hole centres, edge dimensions, and end dimensions. Ask about our standard hole patterns.

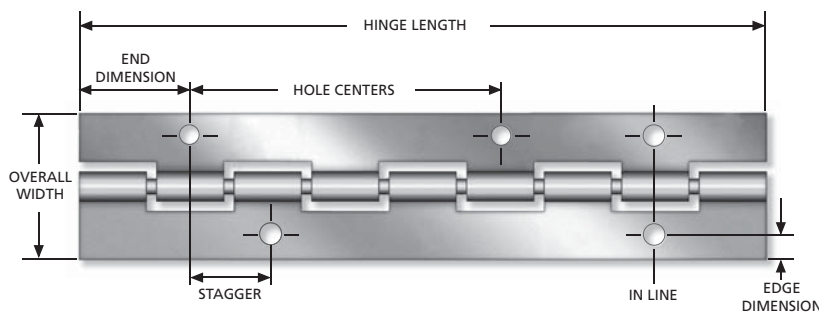

## Common Piercing Designs

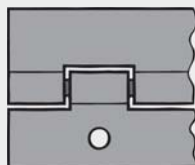

Round

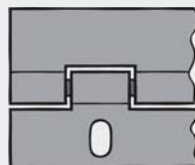

Obround (Vertical)

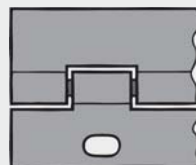

Obround (Horizontal)

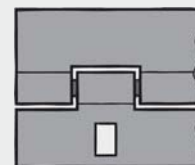

Rectangular (Vertical)

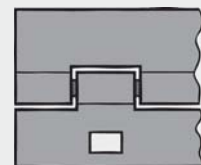

Rectangular (Horizontal)

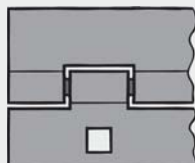

Square

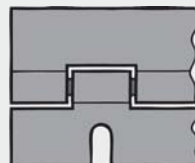

Notch-Radius End

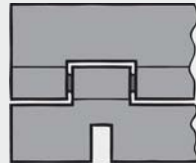

Notch-Square End

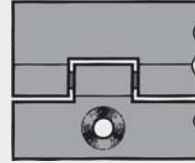

Countersunk or Coined Holes

NOTE: Countersinking is the removal of metal, whereas coining is the displacement of metal, and in some cases will leave a slight bulge on the leaf edge

# Common Continuous Hinge Sizes

Part Number	Gauge	Open Width	Length	Pin Diameter	Knuckle Size	Material
505-1924801	0.030	1.063	72	0.080	0.500	Steel, Nickel plated, 0.2" holes, 2" CTC
505-2903802	0.030	1.063	72	0.090	0.250	Steel, Plain
505-1925801	0.030	1.250	72	0.080	0.500	Steel, Nickel plated, 0.22" holes, 2" CTC
505-P03140917802	0.030	1.250	72	0.090	0.250	Steel, Plain
505-P03140919802	0.030	1.250	96	0.090	0.250	Steel, Plain
505-1923800	0.030	1.500	72	0.080	0.500	Steel, Zinc plated, 0.20" holes, 2" CTC
505-1923801	0.030	1.500	72	0.080	0.500	Steel, Nickel plated, 0.20" holes, 2" CTC
505-1923900	0.030	1.500	72	0.080	0.500	Steel, Black finish, 0.20" holes, 2" CTC
505-1964802	0.040	1.063	72	0.090	0.500	Steel, Plain
505-1920806	0.040	1.500	72	0.090	0.500	Aluminum, 0.19" holes, 2" CTC
505-1925900	0.060	1.500	25	0.125	0.500	Steel, Black finish
505-P06151127805	0.060	1.500	72	0.120	0.500	Stainless Steel
505-2917802	0.060	1.500	72	0.125	0.500	Steel, Plain
505-2917805	0.060	1.500	72	0.125	0.500	Stainless Steel
505-1960806	0.060	1.500	72	0.125	0.500	Aluminum, 0.19" holes, 2" CTC
505-2918802	0.060	2.000	72	0.125	0.500	Steel, Plain
505-P07301837805	0.060	3.000	72	0.187	1.000	Stainless Steel
505-2918806	0.064	2.000	72	0.125	0.500	Aluminum
505-P07202537802	0.075	2.000	72	0.075	0.250	Steel, Plain

Please contact TCH Customer Service (800.465.6281) for availability and price information

## Slip Joint Hinges

Plain Steel (802)



Left Hand "L"

Stainless Steel (805)

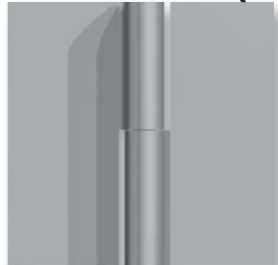

Aluminum (806)



Right Hand "R"

When ordering, replace the Z in the part number with an L or an R for right or left hand pin placement, then replace the XXX with a finish code: 802, 805, or 806.

Example: 505-2825R805, is right handed stainless steel.

Part Number	Gauge	Open Width	Length	Pin Diameter
505-2825ZXXX	.075	1.68	2.00	.187
505-2826ZXXX	.075	1.87	2.50	.187
505-2827ZXXX	.075	2.00	2.00	.187
505-2828ZXXX	.075	2.50	2.50	.187
505-2829ZXXX	.090	2.00	3.00	.187
505-2830ZXXX	.090	2.50	2.50	.187
505-2831ZXXX	.090	3.00	3.00	.250
505-2832ZXXX	.120	3.00	4.00	.250
505-2832ZXXX	.120	4.00	4.00	.250

For "in-stock" information, contact TCH customer service 800.465.6281

### Slip Joint Hinges

Slip-joint or "take apart" hinges are normally used when requirements call for doors to be removed.

- Available in left handed and right handed configurations, in plain steel (802), stainless steel (805), and aluminum (806).
- Leaves and Pin are supplied in the same type of material unless otherwise specified. Steel or aluminum hinges can be supplied with either stainless steel or brass pins.
- Can be pierced, swaged, formed, notched, or plated.
- Can be made to order in other gauges, widths, and lengths.

# Butt Hinges



Plain Steel

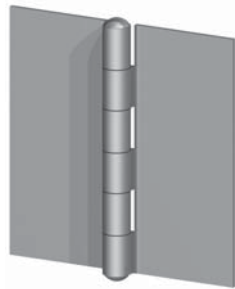

Stainless Steel

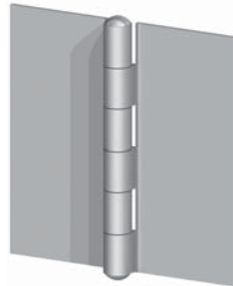

Aluminum

## Butt Hinges

- Available in a wide range of sizes
- Available in plain steel, stainless steel, and aluminum.
- Available with or without holes.

Lead times and minimum order quantities may apply. Please speak to customer service (800.465.6281 ) or your sales representative for information.

# Triangle Strap Hinges

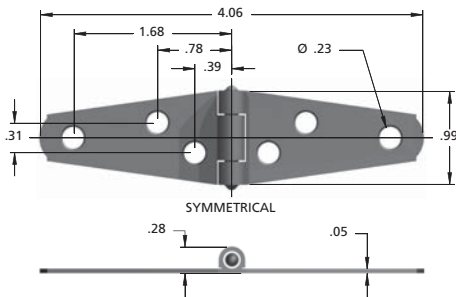

## 505-2002800

### 2" Triangle Strap Hinge

Material: Steel | Color/Finish: Zinc plate | Weight: 0.05 lbs

- All Steel Construction.
- Zinc Plated
- Countersunk Mounting Holes
- Fixed Pin
- Available in sizes ranging from 2" to 12".

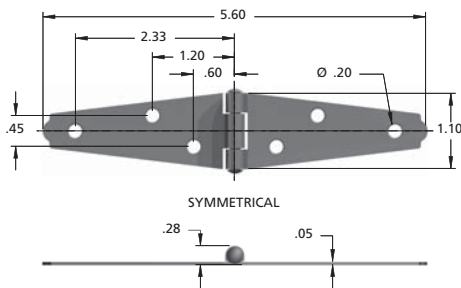

## 505-2003800

### 3" Triangle Strap Hinge

Material: Steel | Color/Finish: Zinc plate | Weight: 0.08 lbs

- All Steel Construction.
- Zinc Plated
- Countersunk Mounting Holes
- Fixed Pin
- Available in sizes ranging from 2" to 12".

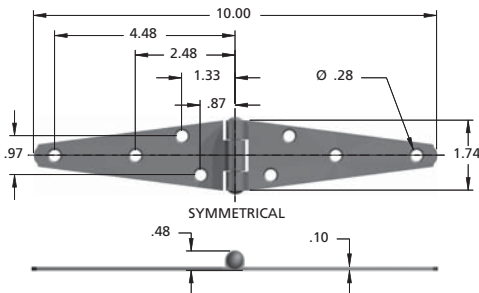

## 505-2005800

### 5" Triangle Strap Hinge

Material: Steel | Color/Finish: Zinc plate | Weight: 0.37 lbs

- All Steel Construction.
- Zinc Plated
- Countersunk Mounting Holes
- Fixed Pin
- Available in sizes ranging from 2" to 12".

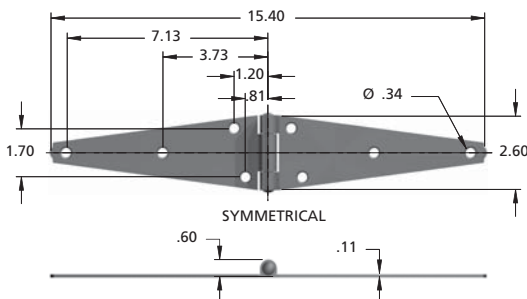

## 505-2008800

### 8" Triangle Strap Hinge

Material: Steel | Color/Finish: Zinc plate | Weight: 0.95 lbs

- All Steel Construction.
- Zinc Plated
- Countersunk Mounting Holes
- Fixed Pin
- Available in sizes ranging from 2" to 12".

# Formed Strap Hinges

## 505-2116800

### 16" Offset Mount Formed Strap Hinge

Material: Steel | Color/Finish: Zinc plate | Weight: 2.19

- Polished stainless steel construction.
- Large 16" x 2" strap.
- Offset overlapping flush mount.
- Washer spacers for easy movement.
- Reversed mounting plate for limited space applications.
- Available as a special order item.

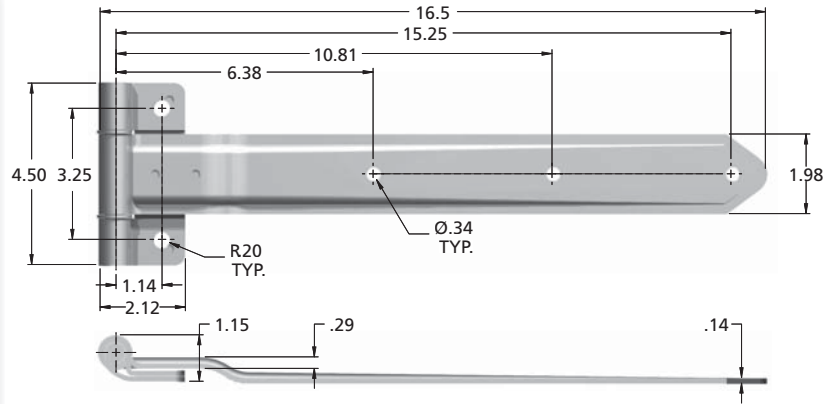

## 505-2108800

### 8" Formed Strap Hinge

Material: Steel | Color/Finish: Zinc plate | Weight: 1.68 lbs

## 505-21085800

### 8" Offset mount Formed strap hinge (not shown)

Material: Steel | Color/Finish: Zinc plate | Weight: 1.68 lbs

- Polished stainless steel construction.
- 8" x 2" strap.
- Straight flush mount.
- Washer spacers for easy movement.
- Available as a special order item.

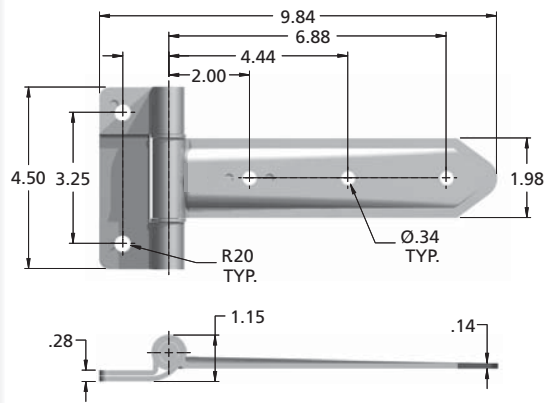

## 505-2103805

### Small Gusset Hinge

Material: Stainless Steel | Finish: Bright Polish | Weight: 0.25 lbs

- Polished stainless steel construction.
- 3" strap length.
- Flush mount.
- Available in left and right hand configurations.
- Countersunk mounting holes.
- Available as a special order item.

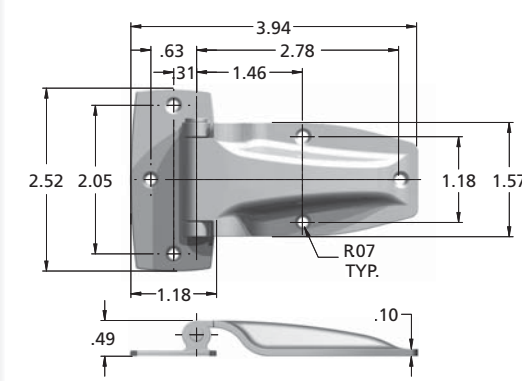

## 505-2105805

### Large Gusset Hinge

Material: Stainless Steel | Finish: Bright polish | Weight: 0.69 lbs

- Polished stainless steel construction.
- 5" strap length.
- Flush mount.
- Available in left and right hand configurations.
- Countersunk mounting holes.
- Available as a special order item.

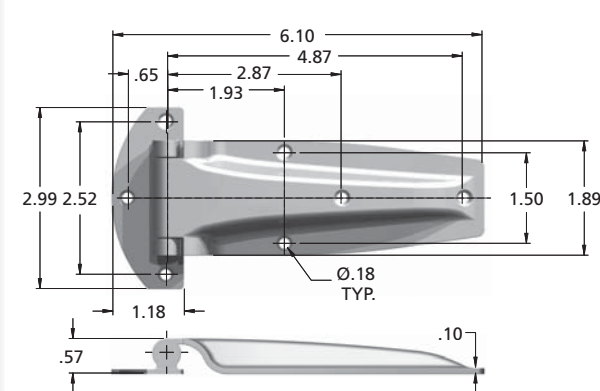

# Polished Stainless Steel Strap Hinges

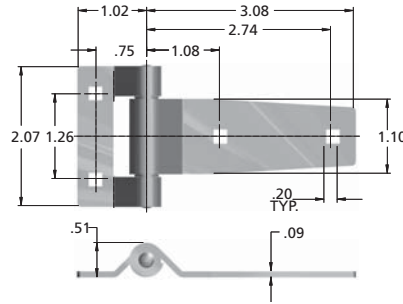

## 505-2203805

### Small Flat Strap Hinge

Material: Stainless Steel | Finish: Bright Polish | Weight: 0.19 lbs

- Polished stainless steel construction.
- Available with round or square holes.
- 3" strap length.

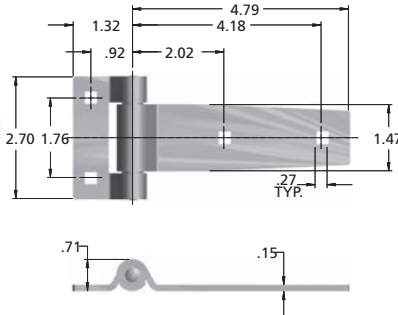

## 505-2205805

### Medium Flat Strap Hinge

Material: Stainless Steel | Finish: Bright Polish | Weight: 0.58 lbs

- Polished stainless steel construction.
- Available with round or square holes.
- 5" strap length.

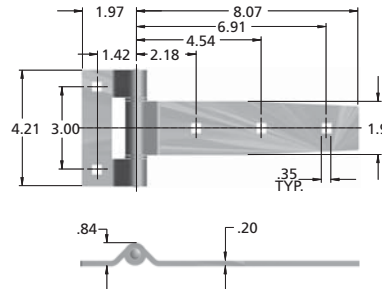

## 505-2208805

### Large Flat Strap Hinge

Material: Stainless Steel | Finish: Bright Polish | Weight: 1.59 lbs

- Polished stainless steel construction.
- Available with round or square holes.
- 8" strap length.
- Washer spacers for easy movement.
- Available as a special order item.

# Polished Stainless Steel Butt Hinges

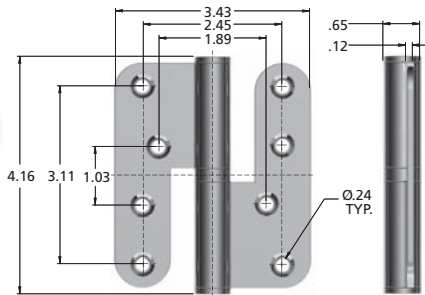

## Removable Slip Hinge

Material: Stainless Steel | Finish: bright polish | Weight: 0.78 lbs

- Polished stainless steel construction.
- Lift-off style hinge.
- Available in left and right hand configurations.
- Washer spacer for easy movement.
- Countersunk mounting holes.
- Available as a special order item.

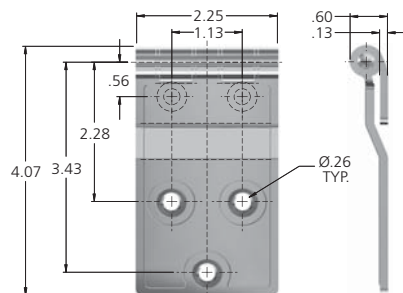

## Overlapping Butt Hinge

Material: Stainless Steel | Finish: Bright Polish | Weight: 0.46

- Polished stainless steel construction.
- Decorative styling.
- Reversed mounting plate for limited space applications.
- Washer spacers for easy movement.
- Countersunk mounting holes.
- Available as a special order item.

# Die-Cast and Plastic Hinges

## 555-96-50-500 & 555-96-10-500 Series In-Line Lift-Off hinges

Material: Die-Cast, Stainless Steel or Plastic | Color/Finish: Black or Polish (SS only)

- Lift-off style allows for removable or fixed applications.
- All mounting hardware is concealed.
- Zinc die-cast construction. Also available in stainless steel, and plastic versions.
- M5 or UNC 10-32 tapped thread holes.

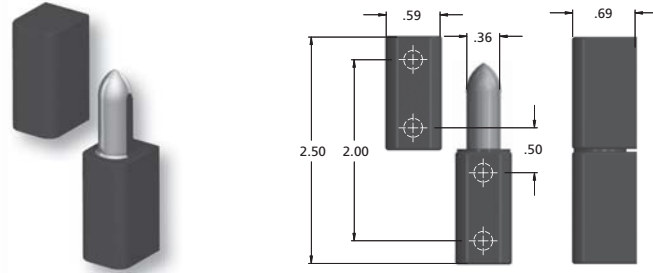

## 555-96-50-510 & 555-96-50-520 series Offset Lift-Off hinges

Material: Die-Cast, Stainless Steel or Plastic | Color/Finish: Black or Polish (SS only)

- Lift-off style allows for removable or fixed applications.
- All mounting hardware is concealed.
- Zinc die-cast construction.
- Available in right or left pin placement.
- M5 or UNC 10-32 tapped thread holes.

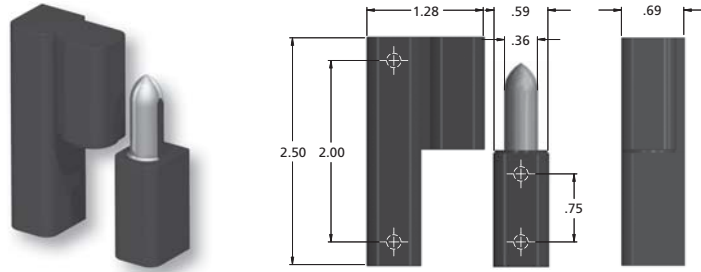

## 555-96-111 & 555-96-112 Series Mini Offset Lift-Off hinges

Material: Die-Cast | Color/Finish: Black

- Lift-off style allows for removable or fixed applications.
- All mounting hardware is concealed.
- Zinc die-cast construction.
- Available in right or left pin placement.
- Also available in an in-line configuration.
- M4x0.7 or UNC 6-32 tapped thread holes.

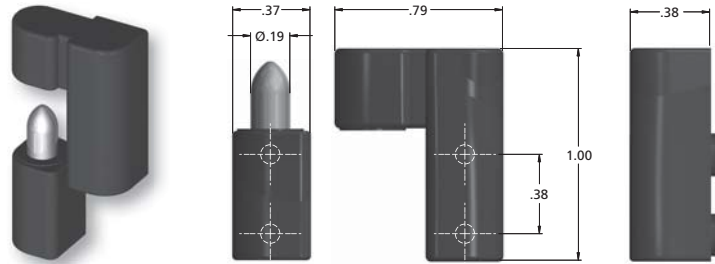

## 555-96-700 Series Decorative Lift-Off hinges

Material: Plastic | Color/Finish: Black or Chrome plate

- Lift-off style allows for removable or fixed applications.
- All mounting hardware is concealed.
- Plastic construction in black or chrome plate.
- Mounts with 4 blind mounting holes.
- Use thread forming screws. (Available, not included)

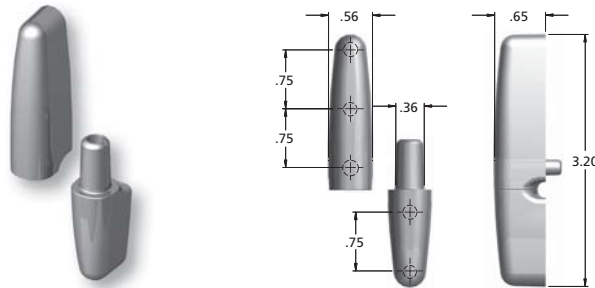

## 555-EH-8 Series Bolt-On Hinge

Material: Brass | Color/Finish: Chrome plate

- Easy to install.
- Zinc die-cast construction.
- 180 degree swing.
- Quick, stud mount for panel/door.
- Threaded stud.

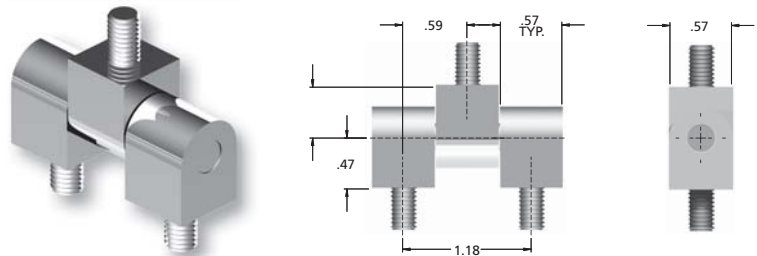

## 555-G6 series Positioning-Advantage Hinge

Material: Plastic | Color/Finish: Black

- Holds door open without secondary mechanical support.
- Holds position at 0, 120, and 170 degrees.
- Snap on covers conceal hardware.
- Free Swinging style available.
- All plastic construction.

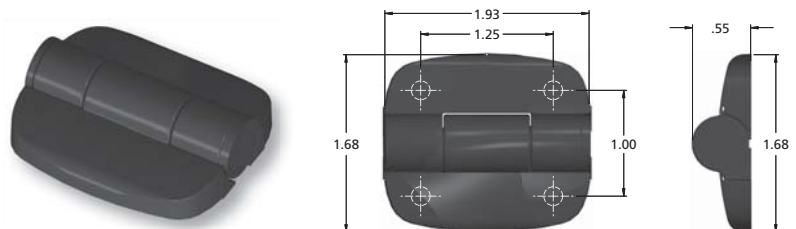

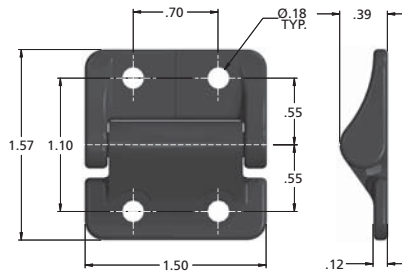

**555-E6-200 & 400 series**

*Constant Torque Friction Hinge*  
Material: Die-Cast, Steel pin | Color/Finish: Black

- Holds door in any position.
- Constant torque through full range of motion.
- Die-cast aluminum construction with steel pin.
- Available in different torque and weight ratings.
- Available in black or natural aluminum.

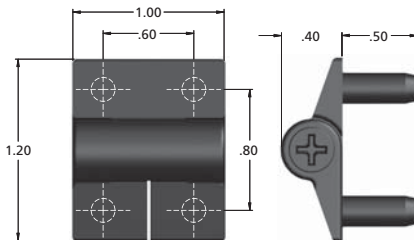

**555-E6-10-101 series**

*Adjustable Friction Hinge*  
Material: Plastic | Color/Finish: Black or White

- Holds door in any position.
- Adjust the holding tension with the turn of a screw.
- Concealed mounting hardware.
- All plastic construction
- Uses zinc plated steel nuts, included.



**Concealed Hinges**

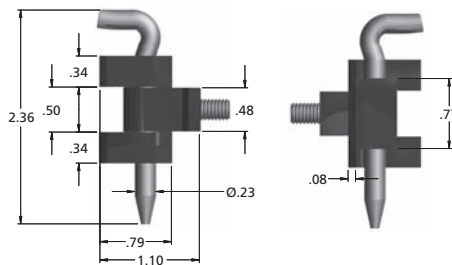

**505-321635900**

*Concealed Hinge Removable Pin*  
Material: Die-cast | Color/Finish: Black | Weight: 0.12 lbs

- Easy to install.
- Zinc die-cast construction.
- Removable pin.
- 180 degree swing.
- Quick, stud mount for panel/door.
- Threaded stud.

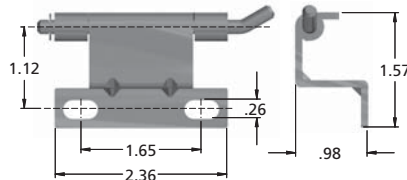
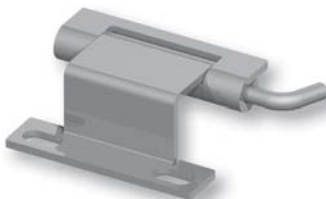

**505-312109800**

*Concealed Adjustable Hinge*  
Material: Steel | Color/Finish: Zinc plate | Weight: 0.19 lbs

**505-312109805**

Material: Stainless Steel | Color/Finish: Plain | Weight: 0.19 lbs

- Concealed, adjustable hinge with 120 degree opening angle.
- Removable pin for quick door removal.
- Reversible left and right, 6 mm of vertical adjustment.

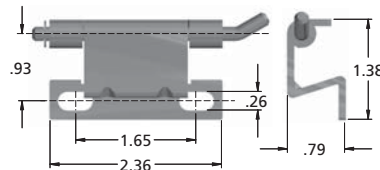
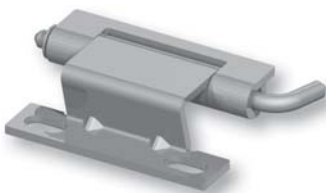

**505-312111800**

*Offset Concealed Adjustable Hinge*

Material: Steel | Color/Finish: Zinc plate | Weight: 0.18 lbs

**505-312111805**

Material: Stainless Steel | Color/Finish: Plain | Weight: 0.18 lbs

- Concealed, adjustable hinge with 120 degree opening angle.
- Removable pin for quick door removal.
- Reversible left and right, 6 mm of vertical adjustment.
- Offset for more compact design

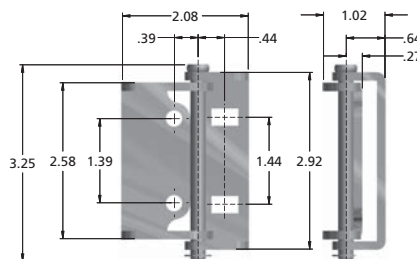
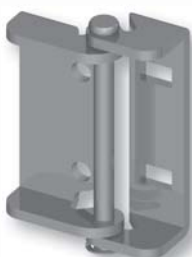

**505-1867800**

*Light Duty Hinge with Removable Pin*

Material: Steel | Color/Finish: Zinc plate | Weight: 0.30 lbs

- Zinc plated steel construction.
- Adjustable mounting holes.
- Removable pin with e-clip for quick door removal.

# Spring Bolt Hinges

## 555-F6-23 Series

### Concealed Removable Hinge

Material: Steel or Stainless Steel | Color/Finish: Zinc plate or Plain

- Mounts inside the frame of formed doors.
- Allows the door to be removed from the hinge side.
- Hinge and hardware are concealed.
- Spring Loaded pins slide for removal.
- Available in plain steel and stainless steel.

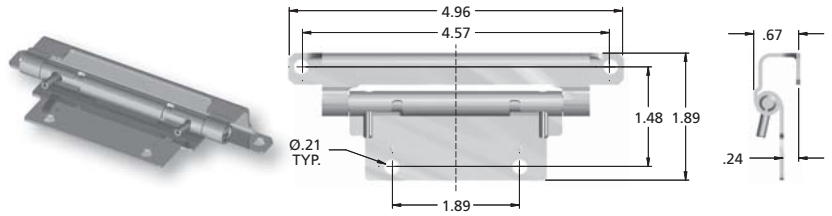

## 555-F6-23 Series

### Removable Spring Pin Hinge

Material: Steel or Stainless Steel | Color/Finish: Zinc plate or Plain

- Zinc plated low carbon steel with a stainless steel spring.
- Easy to install and operate.
- Spring loaded pin slides for easy and quick removal.
- Functions as a hinge or a latch.

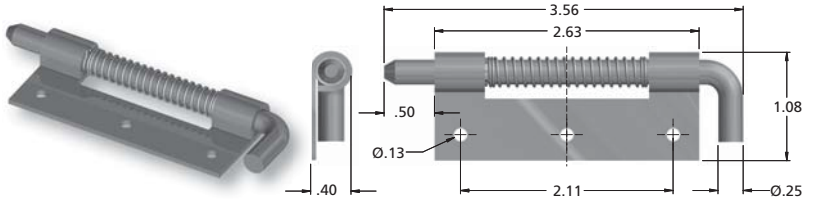

**CEMA**<sup>™</sup>  
POSITIONING TECHNOLOGY

by

**southco**<sup>®</sup>  
CONNECT · CREATE · INNOVATE

## CONSTANT-TORQUE HINGES PROVIDE SMOOTH, RELIABLE POSITIONING FOR DISPLAY SCREENS, PANELS, AND COMPACT APPLICATIONS

CEMA Positioning Technology provides the most versatile range of innovative positioning solutions. It's applications include such industries as: automotive, telecommunications, computers and electronics, and medical.

Choose from frictional-torque, dampening, and stored-energy technologies – in standard or custom designs – for refined ergonomic motion and reliable long-lasting performance in positioning control.

- Available in a broad selection of torque values to satisfy a variety of applications ranging from small antenna adjustment and covers on hand-held electronics, to larger video screens, headrests, and overhead doors.
- Space-efficient designs are available with symmetric torque or asymmetric torque, or counterbalanced to compensate for the weight of a door or panel.
- Rugged construction for long life cycle.
- Smooth operation with zero backlash.

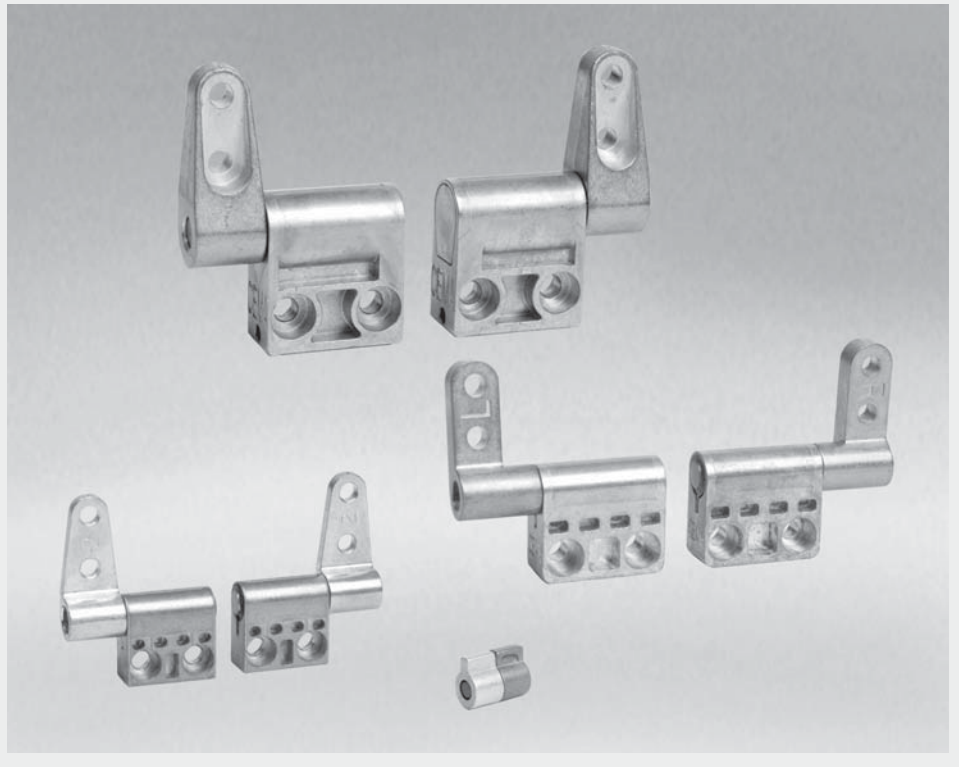

# WELD ON HINGES

## Installation Configurations

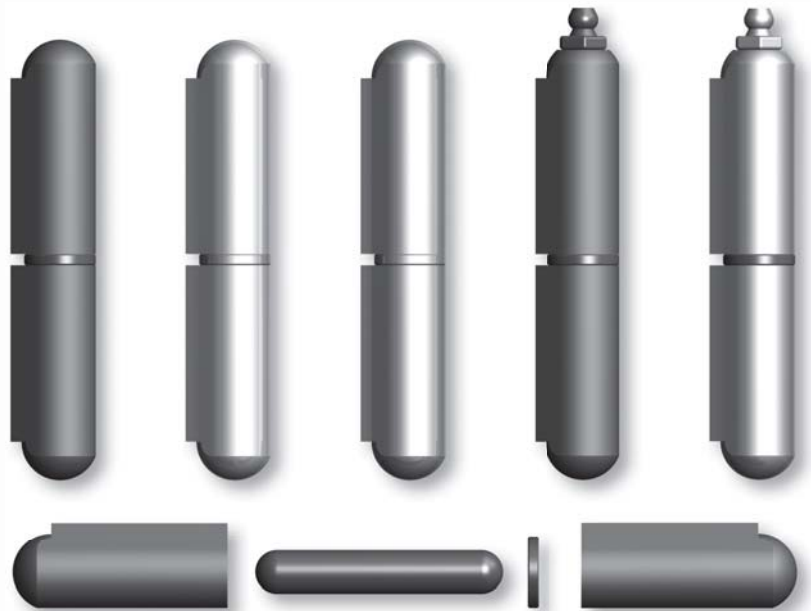
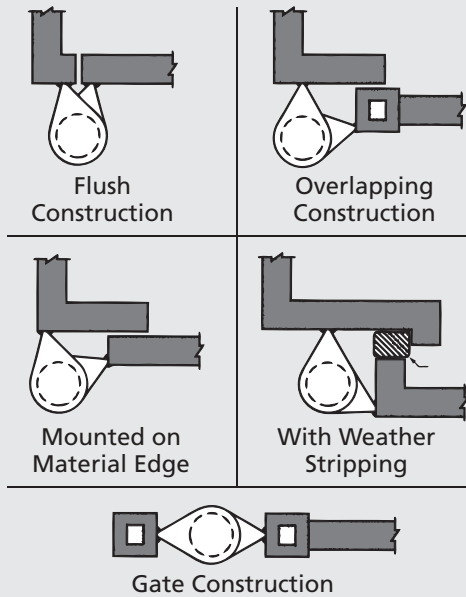

Weld-on Hinges are widely used for electrical enclosures, cab doors, tool boxes, wood stoves, roof hatches, utility and dump bodies, trailers, food service carts, etc.. Made from low carbon steel, stainless steel, and aluminum alloy to service a wide range of applications. Available with fixed pins, and fixed pins with a grease fitting for lubrication.



ALL DIMENSIONS ARE IN INCHES

### STEEL - with steel pin

Part Number	L	D	H	S	P		
505-2834802	1.56	0.31	0.38	0.04	0.20		
505-2836802	S	2.38	0.39	0.47	0.04	0.24	
505-2837802	2.75	0.45	0.52	0.06	0.24		
505-2838802	3.19	0.51	0.61	0.06	0.31		
505-2838G802	3.19	0.51	0.61	0.06	0.31	🔹	
505-2839802	3.50	0.51	0.61	0.06	0.31		
505-2840802	S	4.00	0.63	0.77	0.09	0.39	
505-2840G802	S	4.00	0.63	0.77	0.09	0.39	🔹
505-2841802	S	4.75	0.63	0.77	0.09	0.39	🔹
505-2842802	5.25	0.71	0.90	0.10	0.50		
505-2843802	S	6.00	0.79	0.99	0.12	0.51	
505-2843G802	S	6.00	0.79	0.99	0.12	0.51	🔹
505-2848802	8.00	0.91	1.12	0.12	0.63		

### STEEL - with brass pin

Part Number	L	D	H	S	P		
505-2834BP802	S	1.56	0.31	0.38	0.04	0.20	
505-2835BP802	S	2.00	0.31	0.38	0.04	0.20	
505-2835BP802	S	2.00	0.31	0.38	0.04	0.20	
505-2835BP802	S	2.00	0.31	0.38	0.04	0.20	
505-2835BP802	S	2.00	0.31	0.38	0.04	0.20	
505-2836BP802	2.38	0.39	0.47	0.04	0.24		
505-2837BP802	S	2.75	0.45	0.52	0.06	0.24	
505-2838BP802	S	3.19	0.51	0.61	0.06	0.31	
505-2838BP802	S	3.19	0.51	0.61	0.06	0.31	🔹
505-2840BP802	S	4.00	0.63	0.77	0.09	0.39	
505-2840BP802	S	4.00	0.63	0.77	0.09	0.39	🔹
505-2840BP802	S	4.00	0.63	0.77	0.09	0.39	🔹
505-2841BP802	4.75	0.63	0.77	0.09	0.39		
505-2842BP802	5.25	0.71	0.90	0.10	0.50		
505-2843BP802	S	6.00	0.79	0.99	0.12	0.51	
505-2843BP802	S	6.00	0.79	0.99	0.12	0.51	🔹
505-2848BP802	S	8.00	0.91	1.12	0.12	0.63	

### STAINLESS STEEL - with stainless steel pin

Part Number	L	D	H	S	P	
505-2835805	S	2.00	0.31	0.38	0.04	0.20
505-2836805	S	2.38	0.39	0.47	0.04	0.24
505-2837805	S	2.75	0.45	0.52	0.06	0.24
505-2838805	S	3.19	0.51	0.61	0.06	0.31
505-2840805	S	4.00	0.63	0.77	0.09	0.39
505-2843SPG805	6.00	0.79	0.99	0.12	0.51	🔹
505-2843SSG805	6.00	0.79	0.99	0.12	0.51	🔹
505-2848805	8.00	0.91	1.12	0.12	0.63	

### ALUMINUM - with stainless steel pin

Part Number	L	D	H	S	P		
505-2836806	S	2.38	0.39	0.47	0.04	0.24	
505-2837806	S	2.75	0.45	0.52	0.06	0.24	
505-2838806	S	3.19	0.51	0.61	0.06	0.31	
505-2840806	S	4.00	0.63	0.77	0.09	0.39	
505-2840G806	S	4.00	0.63	0.77	0.09	0.39	🔹
505-2843806	S	6.00	0.79	0.99	0.12	0.51	
505-2843G806	S	6.00	0.79	0.99	0.12	0.51	🔹

Additional sizes and Removable Pins available upon request

S - Stock Item 🔹 - Grease Fitting



**800.465.6281**  
**www.tchweb.com**  
**info@tchweb.com**

Full TCH catalog available upon request



**BUFFALO**

**TCH**  
1370 William Street, Suite 4  
Buffalo NY 14206 U.S.A  
(716) 892-4302 Fax

**DALLAS**

**TCH**  
10552 King William Drive  
Dallas, TX 75220 U.S.A.  
(972) 556-9552 Fax

**TORONTO**

**TCH**  
40 Emblem Court  
Toronto, ON M1S 1B1 Canada  
(416) 299-3255 Fax